

# JSK COLLET

## JSK

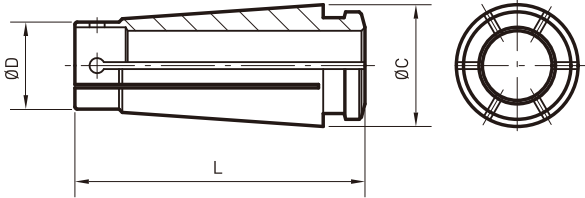

### 강력한 CHUCKING POWER

- 5um(RUN-OUT) 고정밀도
- ENDMILL, DRILL, REAMER 등에 최적합
- 1.0~25.4까지 COLLET가 JSK6, JSK10, JSK16, JSK25의 4가지 STYLE의 본체체 대응하여 준비되어 있습니다.

### Strong Torque Power

- T.I.R below 0,005mm
- Good for Endmill, Drill, Reamer etc.
- Good for deep hole machining

### ORDERING EXAMPLE

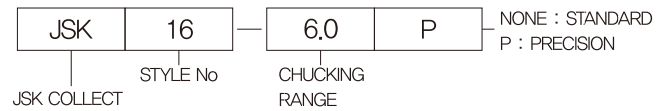

JSK COLLET CHUCK

STYLE	CODE NO.	RANGE
JSK 6	JSK6-2.0	1.5~2.0
	JSK6-2.5	2.0~2.5
	JSK6-3.0	2.5~3.0
	JSK6-3.5	3.0~3.5
	JSK6-4.0	3.5~4.0
	JSK6-4.5	4.0~4.5
	JSK6-5.0	4.5~5.0
	JSK6-5.5	5.0~5.5
JSK 10	JSK10-2.0	1.5~2.0
	JSK10-2.5	2.0~2.5
	JSK10-3.0	2.5~3.0
	JSK10-3.5	3.0~3.5
	JSK10-4.0	3.5~4.0
	JSK10-4.5	4.0~4.5
	JSK10-5.0	4.5~5.0
	JSK10-5.5	5.0~5.5
	JSK10-6.0	5.5~6.0
	JSK10-6.5	6.0~6.5
	JSK10-7.0	6.5~7.0
	JSK10-7.5	7.0~7.5
	JSK10-8.0	7.5~8.0
	JSK10-8.5	8.0~8.5
	JSK10-9.0	8.5~9.0
	JSK10-9.5	9.0~9.5
	JSK10-10.0	9.5~10.0

STYLE	CODE NO.	RANGE
JSK 16	JSK16-3.0	2.5~3.0
	JSK16-3.5	3.0~3.5
	JSK16-4.0	3.5~4.0
	JSK16-4.5	4.0~4.5
	JSK16-5.0	4.5~5.0
	JSK16-5.5	5.0~5.5
	JSK16-6.0	5.5~6.0
	JSK16-6.5	6.0~6.5
	JSK16-7.0	6.5~7.0
	JSK16-7.5	7.0~7.5
	JSK16-8.0	7.5~8.0
	JSK16-8.5	8.0~8.5
	JSK16-9.0	8.5~9.0
	JSK16-9.5	9.0~9.5
	JSK16-10.0	9.5~10
	JSK16-10.5	10~10.5
JSK16-11.0	10.5~11	
JSK16-11.5	11~11.5	
JSK16-12.0	11.5~12	
JSK16-12.5	12~12.5	
JSK16-13.0	12.5~13	
JSK16-13.5	13~13.5	
JSK16-14.0	13.5~14	
JSK16-14.5	14~14.5	
JSK16-15.0	14.5~15	
JSK16-15.5	15~15.5	
JSK16-16.0	15.5~16	

STYLE	CODE NO.	RANGE
JSK 25	JSK25-10.0	9.5~10.0
	JSK25-11.0	10.5~11.0
	JSK25-12.0	11.5~12.0
	JSK25-13.0	12.5~13.0
	JSK25-14.0	13.5~14.0
	JSK25-15.0	14.5~15.0
	JSK25-16.0	15.5~16.0
	JSK25-16.5	16.0~16.5
	JSK25-17.0	16.5~17.0
	JSK25-17.5	17.0~17.5
	JSK25-18.0	17.5~18.0
	JSK25-18.5	18.0~18.5
	JSK25-19.0	18.5~19.0
	JSK25-19.5	19.0~19.5
	JSK25-20.0	19.5~20.0
	JSK25-20.5	20.0~20.5
	JSK25-21.0	20.5~21.0
	JSK25-21.5	21.0~21.5
	JSK25-22.0	21.5~22.0
	JSK25-22.5	22.0~22.5
	JSK25-23.0	22.5~23.0
	JSK25-23.5	23.0~23.5
	JSK25-24.0	23.5~24.0
	JSK25-24.5	24.0~24.5
JSK25-25.0	24.5~25.0	

### DIMENSION

STYLE	JSK6	JSK10	JSK16	JSK25
ØD	7.5	12.0	18.8	28.8
L	25.0	30.6	45.0	57.0
ØC	10.4	15.5	24.6	35.7